



ShanPu

Toggle Switch Series ZTB



UL&ENEC Approved IP68 Sealed or Un-sealed Toggle Switch, up to 20A 125/250 V.
Selection plastic or brass bat type actuator; 1, 2 & 4 pole, 2 or 3 positions, maintained and momentary action.

Application

High-end Technology, Industrial equipment,
Public building, Medical equipment,
Transportation, White goods



Feature

- UL61058-1 approved: (cURus, ENEC15)
- 16(8)A 125/250V~ μ T55, μ T125/55
- 20(8)A 125/250V~ μ T55, μ T125/55
- 20A 6~30VDC, μ T55, μ T125/55
- Contact resistance : 50m Ω max
- Dielectric Strength: 1500 Volts RMS
- Insulation Resistance: 50 Megohms
- Mechanical Life: 50,000 cycles
- Sealed type: UL-recognized IP68 protection level, IP68 for T55
- Unsealed: IP40 for T125/55
- Metal bat or plastic toggle
- Solder, quick connect, screw type or binding terminals
- hex nut, gasket, and rubber boot accessories available upon request.

Materials

- Actuator: Brass
- AL-Tooth Base: Aluminum alloy
- Nuts: SK-5 Carbon steel
- Fixed washer: SK-5 Carbon steel
- Tooth washer: SK-5 Carbon steel
- AL-Rivet: Aluminum alloy
- Base: PA66
- Terminal: Copper alloy plated Silver or Tin

Panel cutting

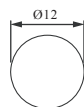

Without KEYWAY

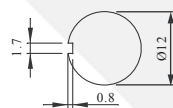

With KEYWAY

How to order



ZTB1-AB11

ON-OFF-ON
16(8)A 125/250V~T55
(cURus / ENEC15)
Quick connect terminal



ZTB1-AB17

(ON)-OFF-(ON) / Momentary
16(8)A 125/250V~T55
(cURus / ENEC15)
Quick connect terminal



ZTB2-AB12

OFF-ON
16(8)A 125/250V~T55
(cURus / ENEC15)
Quick connect terminal



ZTB3-AB37

(ON)-OFF-(ON) / Momentary
16(8)A 125/250V~T55
(cURus / ENEC15)
Solder terminal



ZTB4-AB416

OFF-(ON) / Momentary
16(8)A 125/250V~T55
(cURus / ENEC15)
Screw terminal

KEYWAY

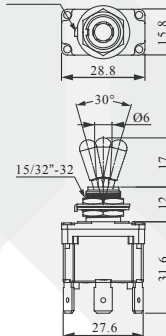

ON	OFF	ON
1-2		2-3



(ON)	OFF	(ON)
(1-2)		(2-3)

()=Momentary



OFF	ON
	2-3

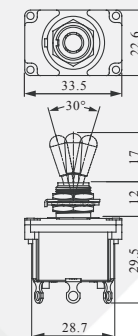

(ON)	OFF	(ON)
(1-2)		(2-3)
(4-5)		(5-6)

()=Momentary

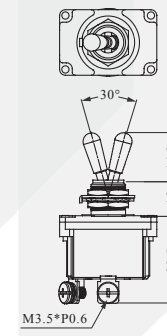

OFF	(ON)
	(2-3)

()=Momentary